



National Council of Supervisors of Mathematics
mathedleadership.org

Charting a Course to Mathematics Leadership 42nd NCSM Annual Conference April 19–21, 2010

Registration

Registration takes place in the Elizabeth Foyer at the following times:

Sunday, April 18 – 2:00 PM to 6:00 PM
Monday, April 19 – 6:45 AM to 5:00 PM
Tuesday, April 20 – 6:45 AM to 12:15 PM
2:15 PM to 5:00 PM
Wednesday, April 21 – 7:30 AM to 10:30 AM

Sponsor Display Area

Visit elite NCSM Sponsor Partners in Elizabeth CDE during the following times:

Monday, April 19 – 11:00 AM to 5:00 PM
Tuesday, April 20 – 8:30 AM to 12:15 PM
2:15 PM to 4:00 PM

NCSM Business Meeting

The NCSM Business Meeting will be held on **Tuesday, April 20, 2:45 PM – 3:45 PM** in Molly AB. All members are invited and encouraged to attend and learn about the State of the Organization.

Caucuses

Caucuses for NCSM regions, international attendees, and past presidents will be held **Tuesday afternoon, April 20, 4:00 to 5:30 PM**. Details and a full schedule of caucuses are found on page 53.

Table of Contents

Welcome Messages	2, 3
Conference Schedule Overview	8
Program Support Committees	4
Program Overview	
Strands and Session Types	5
General Information	
Annual Conference Sponsor Partners	6
Caucuses	6
Commercial Sessions	6
Conference Badges and Bags	5
Conference Feedback	7
Conference Planner	5
Emergency Information	5
Fire Code	5
Local Attractions & Restaurants	7
Lost and Found	7
NCTM Bookstore	7
Non-Smoking Policy	5
Session Changes	6
Session Seating	6
Sponsor Display Area	6
Student Recognition Certificates	7
Taping, Recording, or Photographing Sessions	6
Ticketed Functions Procedures	7
Tips for a Successful Conference Experience	5
Program Summary Information	
Monday	9
Tuesday	33
Wednesday	55
Full Program Details	
Monday	17
Tuesday	41
Wednesday	61
About NCSM	
Awards, Grants, and Recognition	
Iris Carl Mathematics Leadership Fund	77
Ross Taylor/Glenn Gilbert National Leadership Award	77
Student Recognition Certificate	77
Four Decades of NCSM Presidents	74
Future NCSM Conferences and Events	78
Mission and Vision	74
NCSM Annual Conference Committees: 2010 and 2011	81
NCSM Boards: 2009–2010 and 2010–2011	75
NCSM Leadership Academy	78
NCSM Publications	79
Request for Nominations: 2011 NCSM Board Positions	76
Request for Speaker Proposals: 2011 Annual Conference	76
Conference Information	
Sponsor Information	
2009–2010 NCSM Sponsor Partners	83
Guide to Advertisers	86
Commercial Presentations:	
Sponsor Showcases & Technology Showcases	87
Speaker Information	
Index of Speakers	88
Index of Presiders	89
Lead Speaker Contact Information	90
Floor Plans	
Sponsor Display Area	92
Session Rooms	93
Conference Planner	98

President's Message

Welcome to 42nd NCSM Annual Conference in beautiful San Diego California.

As mathematics education leaders, it is our responsibility to continuously work to improve our own professional practice so that we can better support and lead others. Our 42nd Annual Conference—Charting a Course to Mathematics Leadership—is designed to provide you with a rich professional development experience that meets your personal leadership needs. Our conference is a shared learning and leading experience designed to motivate, educate, and inspire us as mathematics leaders to chart our personal course towards the ultimate destination of high quality professional practice for all adults we lead that results in high levels of achievement for all students.

This year's conference features an exciting mix of over 200 sessions by a variety of speakers—individuals from outside of mathematics education as well as mathematics education leaders; first-time speakers, veterans, and perennial favorites—who will address current issues related to equity and access as well as leadership of curriculum, teaching and learning, and assessment, including both NCTM's new high school mathematics curricular recommendations and the Common Core State Standards Initiative of the National Governors Association and Council of Chief State School Officers. Putting PRIME into Practice sessions highlight how leaders have used the NCSM PRIME Leadership Framework as a tool at the school, district, and state levels to change adult practices and increase student achievement.

New this year is our Developing Coaches—Developing Teachers strand, designed to meet the leadership needs of mathematics coaches and those responsible for supporting coaches and developing coaching programs. Our Monday program features a cluster of sessions of special interest to administrators at all levels, and our Wednesday

program features sessions of special interest to emerging mathematics education leaders.

Our Conference also provides a unique opportunity to network with national and international colleagues around issues of mathematics education leadership. Be sure to take advantage of scheduled networking opportunities, such as the Caucuses and Special Interest Group sessions, as well as the informal opportunities throughout the conference.

Many thanks to hundreds of NCSM members who have offered their time to ensure the Annual Conference is a valuable professional learning experience, including speakers, program reviewers, and on-site volunteers. I especially want to recognize Cathy Carroll, Linda Fulmore, Sandie Gilliam, Sara Munshin, Janet Falkowski, and Lynn Raith who have voluntarily dedicated countless hours to make this conference a valuable experience for each of you. Thanks also to NCSM staff members who support the work of the NCSM Board—Terri Belcher, Dorothy Shadrick, and Danette Garlock. Please take time to visit and thank our Sponsor Partners for their support of this Annual Conference and other NCSM activities.

Enjoy this opportunity to continue your professional learning with national and international mathematics education leaders. Have a wonderful conference!

Diane J. Briars
NCSM President

Welcome to San Diego and the 42nd NCSM Annual Conference

We are glad you have joined us for the 42nd NCSM Annual Conference. These three days promise to be an exciting learning experience, offering you an opportunity to take advantage of over 180 sessions and events including:

- Monday morning's Opening Session with Diane J. Briars, NCSM President; Terri Belcher, NCSM Executive Director; and Linda Fulmore, Program Chair. Welcoming remarks will be provided by Dr. Nancy Giberson, Assistant Superintendent, San Diego County Office of Education
- Keynote Address by Mike Schmoker, a leading educational researcher, author, and advocate for educational excellence
- Twelve Major Sessions featuring renowned speakers on a variety of key topics of interest to mathematics educational leaders
- A new strand for 2010—Developing Coaches, Developing Teachers
- A lineup of special focus sessions of interest to school administrators on Monday and to emerging leaders on Wednesday
- NCSM Business Meeting on Tuesday, April 20, 2010, 2:45 PM – 3:45 PM, Molly AB

- Tuesday afternoon Caucuses and Wednesday afternoon Special Interest Group Meetings
- Elite Sponsor Displays on Monday and Tuesday
- Sponsor Showcases on Monday, Tuesday, and Wednesday
- Technology Showcases on Monday and Tuesday
- Sponsored breakfasts, lunches, and reception

The conference committee is grateful to all those whose interest and efforts help to make the conference a rewarding experience for all those in attendance:

- Those who submitted proposals to speak—for your willingness to share your ideas and experience with your colleagues
- Program Proposal Reviewers—for your time and efforts in carefully reviewing the many proposals that were submitted for the program
- On-Site Program Committee—for supporting our speakers and taking care of their on-site needs
- Local Support Committee—for helping to ensure a smooth-running conference
- NCTM and Manchester Grand Hyatt Conference Services—for supporting logistics and on-site needs



Cathy Carroll,
Conference Coordinator,
San Mateo, CA



Linda Fulmore,
Program Chair,
Cave Creek, AZ



Sandie Gilliam, Volunteer
Recruitment & Management
Chair, Colorado Springs, CO



Diane J. Briars, President,
Pittsburgh, PA



Janet R. Falkowski,
Sponsor Liaison,
Pittsburgh, PA



Lynn Raith,
Sponsor Liaison,
Pittsburgh, PA



Sara Munshin,
Local Support Chair,
Los Angeles, CA



Danette Garlock,
Conference & Event
Services Manager,
Denver, CO



Terri K. Belcher,
Executive Director,
Berkeley, CA

2010 Program Proposal Reviewers

Linda Fulmore, Program Chair

Comfort Akwaji-Anderson Iowa City, IA	Susana Davidenko Jamesville, NY	Charlene Marchese Livingston, NJ	Sherry Stokes Olympia Fields, IL
Cheryl Avalos Hacienda Heights, CA	Sandie Gilliam Colorado Springs, CO	Lois Moseley Houston, TX	Mona Toncheff Phoenix, AZ
Jim Barta Salt Lake City, UT	Fred Gross Newton, MA	Sara Munshin Los Angeles, CA	Fern Tribbey Northbrook, IL
Susan Beal Chicago, IL	Mike Hall Jonesboro, AR	Karen Norwood Raleigh, NC	Denise Walston Norfolk, VA
Nadine Bezuk Poway, CA	Dawn Jenkins Pleasant Garden, NC	Marianne O'Connor Pittsburgh, PA	Susan Weiss Brookline, MA
Nancy Bunt Homestead, PA	Doyt Jones Philadelphia, PA	Marge Scieska Greenville, SC	Colleen Williamson Pittsburgh, PA
Marcelline Carr Little Rock, AR	Norma Jost Austin, TX	Fredrick Silverman Greely, CO	
Ralph Connelly Fonthill, ON	Steve Klass San Diego, CA	Peg Smith Pittsburgh, PA	

2010 On-Site Program Committee

Comfort Akwaji-Anderson Iowa City, IA	Nadine Bezuk Poway, CA	Norma Jost Austin, TX	Sherry Stokes Olympia Fields, IL
Cheryl Avalos Hacienda Heights, CA	Nancy Bunt Homestead, PA	Steve Klass San Diego, CA	Mona Toncheff Phoenix, AZ
Jim Barta Salt Lake City, UT	Marcelline Carr Little Rock, AR	Donna Simpson Leak Chicago, IL	Fern Tribbey Northbrook, IL
Susan Beal Chicago, IL	Ralph Connelly Fonthill, ON	Charlene Marchese Livingston, NJ	Denise Walston Norfolk, VA
Jennifer Bednarczyk Monee, IL	Carol Edwards Chandler, AZ	Chadd McGlone Chapel Hill, NC	Colleen Williamson Pittsburgh, PA
	Valerie Elswick Cape Coral, FL	Marianne O'Connor Pittsburgh, PA	

2010 Local Support Committee

Sara Munshin, Chair, Los Angeles, CA

Cheryl Avalos Hacienda Heights, CA	Diane Kinch Claremont, CA	Jeannie Toshima South Pasadena, CA
Nancy Dricky McMinnville, OR	Patty Sandoz LaGrande, OR	

Program Overview

Strands

1. **Charting a Course to Equity and Access** – Addresses issues regarding helping teachers develop the knowledge and skills necessary to ensure access to meaningful mathematics and mathematics learning for every student.
2. **Charting a Course to Curriculum Leadership** – Focuses on leaders' work of develop teachers' knowledge and skills necessary to ensure relevant and meaningful mathematics in every lesson.
3. **Charting a Course to Teaching and Learning Leadership** – Addresses the knowledge and skills necessary to ensure high quality mathematics instruction that meets the needs of every student, every day.
4. **Charting a Course to Assessment Leadership** – Addresses monitoring of student learning and adjustment of teacher instruction for every student on a daily basis.
5. **Putting PRIME into Practice** – Focuses on NCSM's PRIME Leadership Framework. This document outlines adult leadership actions that ensure success for every leader, every teacher and every student.
6. **Developing Coaches – Developing Teachers** – Provides models to support and encourage teachers for education reform in enhancing mathematics teaching and learning in their classrooms.

Session Types

- *Opening Session with Keynote Address*
- *NCSM Business Meeting*
- *NCSM Caucus Sessions*—Tuesday afternoon, 90 minutes
- *Major Sessions*—Monday, Tuesday, and Wednesday, 60 minutes each
- *Regular Sessions*—Monday, Tuesday, and Wednesday, 60 minutes each
- *Double Sessions*—Monday, 120 minutes each
- *Extended Sessions*—Tuesday and Wednesday, 90 minutes each
- *Sponsor Showcases*—Monday, Tuesday, and Wednesday, 60 minutes each
- *Technology Showcases*—Monday and Tuesday, 60 minutes each
- *Special Interest Group Meetings*—Wednesday afternoon, 75 minutes

General Information

Emergency Information

Call 911 for any medical emergencies.

Fire Code

Fire code regulations apply to all conference session rooms. Sessions will be closed when seating capacity is reached. Regulations require that there is no standing, no sitting on the floor, and no moving of chairs from another room. We appreciate your cooperation in this matter.

Non-Smoking Policy

The NCSM Conference is a non-smoking event. Those who wish to smoke must do so outside the building in designated smoking areas.

Conference Badges and Bags

NCSM Conference name badges must be worn by attendees for admittance to conference sessions, meal functions, and the sponsor display area. Your conference badge also provides you admittance to the NCTM Bookstore on Wednesday.

One NCSM Conference bag is given to each registered participant who has an exchange ticket for the bag, as long as supplies last. Replacement bags and extra bags will not be distributed at the conference.

Conference Planner

A conference planner, located on page 98, is for your use in choosing a schedule of sessions and events to attend. Because all rooms have a limited seating capacity, it is suggested that you select at least one alternate session for each time slot in case your first choice is full.

Tips for a Successful Conference

If this is your first NCSM Conference, be sure to attend the First Timer's Session on Monday morning

- Become familiar with the locations of the session rooms and other conference venues
- Use the Conference Planner (page 98) to outline your daily schedule
- Be sure to select alternate session in each time slot in case your first choice is full
- Network with colleagues and share experiences about the different sessions you attend
- Turn off cell phones during sessions and functions
- Visit the Sponsor Display Area in Elizabeth CDE on Monday or Tuesday
- Attend the Sponsor Showcases and Technology Showcases to learn about the latest educational products

Session Changes

The listings in this program book represent the latest conference information (as of publication date) and supersede all previously printed information. Be sure to also check the Program Supplement included in your conference bag for any last-minute revisions. NCSM reserves the right to change speakers, facilities, or program content at any time.

Session Seating

Rooms have been set to conform to the fire code. As per fire marshal orders, only those seated in chairs will be allowed to remain in the meeting rooms. Seating at all sessions is on a first-come-first-served basis.

Taping, Recording, or Photographing Sessions

Written permission to tape, record, or photograph sessions must be obtained directly from the speaker(s) before the session begins. The request must contain a statement indicating the intended use of such a tape, recording, or photograph as well as your name and contact information. A copy of the request should be given to the lead speaker.

NCSM Business Meeting

The NCSM Annual Business Meeting will take place on Tuesday, April 20, 2010, from 2:45 PM to 3:45 PM in Molly AB.

Caucuses

The Caucuses are perfect opportunities for all conference attendees to network, collaborate, and communicate within each NCSM region. During the sessions, participants will:

- Identify and discuss national issues
- Enhance leadership capacity
- Share information on opportunities for professional development for math leaders
- Promote networking among members
- Provide avenues for personal leadership in NCSM

Caucuses are for all national and international NCSM attendees and past presidents. The sessions will be held Tuesday afternoon, April 20, 4:00 PM – 5:30 PM. See page 53 for the full schedule.

Refreshments will be served and door prizes will be drawn at each caucus.

Commercial Sessions

The conference program includes two types of commercial sessions. See the daily schedule for details about each of the sessions.

- **Sponsor Showcases** are provided by NCSM elite sponsor partners to share information about their products.
- **Technology Showcases** focus on the latest products related to the use of technology.

Sponsor Display Area

The Sponsor Display Area has become an integral part of the educational services NCSM provides conference attendees. Attendees can examine current resources, explore trends and practices, review products and services and engage in discussion with NCSM's elite sponsor partners. Be sure to make time in your schedule to visit the NCSM Sponsor Display Area in Elizabeth CDE. Wear your conference name badge to gain entrance.

Hours:

Monday, April 19	11:00 AM – 5:00 PM
Tuesday, April 20	8:30 AM – 12:15 PM 2:15 PM – 4:00 PM

NCSM Annual Conference Sponsor Partners

Many sponsors generously support NCSM and its membership throughout the year. Acknowledgement of all NCSM sponsor partners for their contributions can be found starting on page 83.

We thank the following sponsors for their contribute to events related to the NCSM Annual Conference.

- Conference Program Book—**CORD Communications, Inc.**
- Conference Bags—**Pearson**
- Conference Mugs—**ETA/Cuisenaire**
- Conference Neck Wallet—**Tom Snyder Productions, a Scholastic Company**
- Conference Media Production—**It's About Time**
- Conference Signage—**Educators Outlet and ExploreLearning**
- Cyber Cafe—**Encyclopaedia Britannica**
- Travel Alarm Clock—**EAI Education**
- Luggage Tags—**Educator's Outlet**
- Magnetic Refrigerator Clip—**ExploreLearning**
- *Faster Isn't Smarter* by Cathy Seeley—**Math Solutions**
- Monday Continental Breakfast—**MIND Research Institute**
- Monday Box Lunch—**Didax**
- Tuesday Breakfast—**Tom Snyder Productions, a Scholastic Company**
- Tuesday Luncheon—**Texas Instruments**
- Tuesday Reception—**Pearson**
- Wednesday Breakfast—**America's Choice**
- Wednesday Lunch—**CASIO America, Inc. and Houghton Mifflin Harcourt**

Ticketed Functions

Special Note for Monday's Box Lunch

Attendees with tickets for the box lunch may pick up a lunch any time between 11:30 AM and 12:45 PM in the Sponsor Display area in Elizabeth CDE on the 2nd floor. Remaining lunches, if any, will be available on a first-come-first-served basis starting at 12:45 PM.

Frequently Asked Questions

Are meal function tickets automatically included in my registration? Meal functions are not included in the conference registration fee. Some of our sponsor partners graciously agree to host a meal function and provide a certain number of meals within their budget. An admission ticket was provided in your registration packet if a seat was available for a particular function WHEN YOU REGISTERED.

I have a meal ticket. Does that guarantee me a seat no matter what time I show up? If you have a ticket, don't be late! Experience has shown that some people with tickets opt to sleep in some mornings or chose to socialize with friends in outside restaurants at the last minute. In order to allow as many attendees as possible to enjoy the meal functions, when the ticketed line goes through, the waiting line will follow as soon as possible. If you are late, you may not get the meal for which you have a ticket. Please be on time.

What do I do with a meal function ticket I have, that I no longer need? You may turn in any tickets you won't use to the NCSM conference registration booth. This will enable some without tickets to get into the event. You may also hand them to Sandie Gilliam, at any time during the conference.

What happens if people with tickets don't show up to claim their meal? Might I be able to get in? Unfortunately for both the sponsors and the conference attendees, many meals at last year's conference went uneaten when people with tickets didn't attend the meal function. This year, the waiting line will be permitted in to eat once the ticketed line goes through and the start time for the function is reached. Depending on the function, there is a good chance of getting in, especially if you get in line early!

Is there a waiting list/waiting line for meal functions? Those without tickets may wait in the special line that will form to the side of the ticketed line, and will be let in as space becomes available after the ticketed line goes through.

Special Interest Group Meetings

A number of educational groups participate in NCSM's Special Interest Group meetings on Wednesday afternoon from 2:45 PM to 4:00 PM. This year's SIG sessions are:

- Association of Mathematics Teacher Educators (AMTE)
- Educational Consultants: A Networking Opportunity
- Emerging Leaders: Focus Question/Answer Time
- Equity in Mathematics Education: TODOS

- Improving Math Education for Students with Special Needs
- Lessons Learned from Experiments in Our Charter Schools
- Leading Mathematics Education of Marginalized Students (NASGEM)
- Lesson Study Networking
- Math 2.0: A New Vision for Using Dynamic Math Software with Web 2.0 Tools (CLIME)
- Math Contests Build Better Students — and Teachers
- Mathematics Content Coaching
- Nuances and Complexities of Teaching Mathematics for Cultural Relevance and Social Justice (Benjamin Banneker Association)
- Nurturing Mathematically Promising and Creative Students
- Urban Mathematics Leadership Network Forum

Student Recognition Certificates

NCSM provides certificates as a means of honoring students who excel in the study of mathematics. All public, private, and parochial schools, as well as colleges and universities, that have at least one NCSM member in the area, are eligible to participate. Each school may receive up to two awards per year per graduating class or grade level. Pick up certificates at the registration booth. More information about these certificates is available at mathedleadership.org.

Conference Feedback

You will receive an email in the week following the conference inviting you to share your feedback with the conference committee. We encourage you to take the time to complete the online survey, as your thoughts and opinions will be helpful to the planners of the 43rd NCSM Annual Conference to be held in Indianapolis, IN, April 11-13, 2011.

Lost and Found

If you find an article you believe belongs to someone attending the NCSM Conference, please bring it to the NCSM registration booth in the Elizabeth Foyer on the 2nd floor. Articles will be held there until 10:30 AM on Wednesday, at which time they will be turned over to the hotel.

NCTM Bookstore

The NCTM Bookstore is open to all NCSM registrants on Wednesday, April 21, from 10:00 AM to 5:00 PM in the San Diego Convention Center. NCSM registrants wearing their NCSM Conference badges will receive a 25% discount on purchases that day.

Local Attractions and Restaurants

With Seaport Village just outside the hotel's back door, the Gaslamp District a few blocks away, and Old Town a short trolley ride up the road, you'll surely be able to find great places to eat and things to do in your spare time. For more specific information, check with the hotel concierge desk.

2010 Conference Schedule Overview

All Sessions and Events are held in the Manchester Grand Hyatt Hotel.

Date and Time	Event	Location
Monday, April 19		
6:45 AM – 5:00 PM	<i>Advance & On-site Registration</i>	Elizabeth Foyer
6:45 AM – 7:30 AM	Complimentary Continental Breakfast – MIND Research Institute	Douglas Foyer
7:30 AM – 9:00 AM	Opening Session & Keynote	Douglas Pavilion CD
9:30 AM – 10:30 AM	Major and Regular Sessions & Commercial Sessions	Levels 2, 3, 4
9:30 AM – 11:30 AM	Double Sessions	Levels 2, 3, 4
10:45 AM – 11:45 AM	Major and Regular Sessions & Commercial Sessions	Levels 2, 3, 4
11:00 AM – 5:00 PM	<i>Sponsor Displays</i>	Elizabeth CDE
11:30 AM – 12:45 PM	Box Lunch – Didax (<i>ticket required</i>)	Elizabeth CDE
12:45 PM – 1:00 PM	Box Lunch Wait Line (<i>first come, first served</i>)	Elizabeth CDE
12:00 PM – 2:00 PM	Double Sessions	Levels 2, 3, 4
12:15 PM – 1:15 PM	Major and Regular Sessions & Commercial Sessions	Levels 2, 3, 4
1:30 PM – 2:30 PM	Major and Regular Sessions & Commercial Sessions	Levels 2, 3, 4
2:45 PM – 3:45 PM	Major and Regular Sessions & Commercial Sessions	Levels 2, 3, 4
2:45 PM – 4:45 PM	Double Sessions	Levels 2, 3, 4
4:00 PM – 5:00 PM	Major and Regular Sessions & Commercial Sessions	Levels 2, 3, 4
5:15 PM – 6:45 PM	Regional Leadership Team Meeting (<i>by invitation only</i>)	
Tuesday, April 20		
6:45 am–12:15 pm	<i>Advance & On-site Registration</i>	Elizabeth Foyer
7:30 AM – 8:30 AM	Breakfast – Tom Snyder Productions, A Scholastic Company (<i>ticket required</i>)	Douglas Pavilion CD
8:30 AM – 12:15 PM	<i>Sponsor Displays</i>	Elizabeth CDE
8:45 AM – 9:45 AM	Major and Regular Sessions & Commercial Sessions	Levels 2, 3, 4
8:45 AM – 10:15 AM	Extended Sessions	Levels 2, 3, 4
10:15 AM – 11:15 AM	Major and Regular Sessions & Commercial Sessions	Levels 2, 3, 4
10:30 AM – 12:00 PM	Extended Sessions	Levels 2, 3, 4
12:15 PM – 2:15 PM	Luncheon – Texas Instruments (<i>ticket required</i>)	Douglas Pavilion CD
2:15 PM – 4:00 PM	<i>Sponsor Displays</i>	Elizabeth CDE
2:15 PM – 5:00 PM	<i>Advance & On-site Registration</i>	Elizabeth Foyer
2:30 PM – 3:30 PM	Major and Regular Sessions & Commercial Sessions	Levels 2, 3, 4
2:30 PM – 4:00 PM	Extended Sessions	Levels 2, 3, 4
4:00 PM – 5:30 PM	Caucus Meetings	Levels 2, 3, 4
5:45 PM – 7:00 PM	Reception – Pearson (<i>ticket required</i>)	Douglas Pavilion CD
Wednesday, April 21		
7:30 AM – 10:30 AM	<i>Advance & On-site Registration</i>	Elizabeth Foyer
7:30 AM – 8:30 AM	Breakfast – America's Choice (<i>ticket required</i>)	Douglas Pavilion CD
8:45 AM – 9:45 AM	Major and Regular Sessions	Levels 2, 3, 4
8:45 AM – 10:15 AM	Extended Sessions	Levels 2, 3, 4
10:15 AM – 11:15 AM	Major and Regular Sessions	Levels 2, 3, 4
10:30 AM – 11:30 AM	Extended Sessions	Levels 2, 3, 4
11:15 AM – 12:15 PM	Major and Regular Sessions	Levels 2, 3, 4
12:30 PM – 2:30 PM	Luncheon – CASIO America, Inc. & Houghton Mifflin Harcourt (<i>ticket required</i>)	Douglas Pavilion CD
2:45 PM – 4:00 PM	Special Interest Group Meetings	Levels 2, 3, 4

Note: Commercial Sessions = Sponsor Showcases & Technology Showcases



National Council of Supervisors of Mathematics

mathedleadership.org

NCSM Mission

The National Council of Supervisors of Mathematics (NCSM) is a mathematics leadership organization for educational leaders that provides professional learning opportunities necessary to support and sustain improved student achievement.

NCSM Vision

NCSM envisions a professional and diverse learning community of educational leaders that ensures every student in every classroom has access to effective mathematics teachers, relevant curricula, culturally responsive pedagogy, and current technology.

To achieve our NCSM vision, we will:

- N** Network and collaborate with stakeholders in education, business, and government communities to ensure the growth and development of mathematics education leaders
- C** Communicate to mathematics leaders current and relevant research, and provide up-to-date information on issues, trends, programs, policies, best practices, and technology in mathematics education
- S** Support and sustain improved student achievement through the development of leadership skills and relationships among current and future mathematics leaders
- M** Motivate mathematics leaders to maintain a life-long commitment to provide equity and access for all learners

Four Decades of NCSM Presidents

We honor the legacy of former NCSM Presidents and value their contribution, support, and leadership.

2007–2009	Timothy D. Kanold	1987–1989	Iris M. Carl
2005–2007	Linda M. Gojak	1985–1987	David R. Johnson
2003–2005	Kay Gilliland	1983–1985	Sally Sloan
2001–2003	Carole Greenes	1981–1983	Shirley Frye
1999–2001	Jerry Cummins	1979–1981	Thomas Rowan
1997–1999	Bonnie Walker	1977–1979	Dorothy Strong
1995–1997	Steven Leinwand	1975–1977	Alexander Tobin
1993–1995	L. Carey Bolster	1973–1975	Arthur Frier
1991–1993	Henry Kepner	1971–1973	Ross Taylor
1989–1991	Larry Bradsby	1969–1971	Louis Scholl

2009–2010 NCSM Board Members

Elected

President – Diane J. Briars
Immediate Past President – Timothy D. Kanold
1st Vice President – Linda Fulmore
2nd Vice President – Sandie Gilliam
Regional Directors:
Canadian Region – Donna Karsten
Central Region 1 – Steve Viktora
Central Region 2 – Connie Schrock
Eastern Region 1 – Laurie Boswell
Eastern Region 2 – Diana G. Kendrick
Southern Region 1 – Susan Birnie
Southern Region 2 – Suzanne Mitchell
Western Region 1 – Richard Seitz
Western Region 2 – Sara Munshin

Appointed

Awards Chair – Donna Simpson Leak
Conference Coordinator – Cathy Carroll
eNEWS and Web Editor – James Lynn
Journal Editor – Linda Ruiz Davenport
Membership & Marketing Chair – Ruth Harbin Miles
NCTM Representative – Jerry Cummins
Newsletter Editor – Kay Gilliland
Nominations Chair – Kim Hall
Position Papers Editor – Kit Norris
Secretary – Janet Sinopoli
Sponsor Liaisons – Janet R. Falkowski & Mary Lynn Raith
Treasurer – Randy Pippen

2010–2011 NCSM Board Members

Elected

President – Diane J. Briars
President Elect – Suzanne Mitchell
1st Vice President – Sandie Gilliam
2nd Vice President – Denise M. Walston
Regional Directors:
Canadian Region – Donna Karsten
Central Region 1 – Valerie L. Mills
Central Region 2 – Connie Schrock
Eastern Region 1 – Mari Muri
Eastern Region 2 – Diana G. Kendrick
Southern Region 1 – Susan Birnie
Southern Region 2 – Ted H. Hull
Western Region 1 – Richard Seitz
Western Region 2 – Sara Munshin

Appointed

Awards Chair – Donna Simpson Leak
Conference Coordinator – Cathy Carroll
eNEWS and Web Editor – Don Scheuer
Journal Editor – Linda Ruiz Davenport
Membership & Marketing Chair – Ruth Harbin Miles
NCTM Representative – Jerry Cummins
Newsletter Editor – Kay Gilliland
Nominations Chair – Kim Hall
Position Papers Editor – Kit Norris
Secretary – Janet Sinopoli
Sponsor Liaisons – Janet R. Falkowski & Mary Lynn Raith
Treasurer – Randy Pippen

NCSM Professional Services

2009–2010

Executive Director – Terri K. Belcher
Annual Conference Housing Bureau – Wyndham Jade
Journal Technical Editor – Jim Conrey and Bonnie Katz
Member & Conference Services – Association, Conferences & Exhibition Management, Inc.
Newsletter Technical Editor – Paul Giganti and Deborah Anker, BesType
Technology Liaison – Charlene Chausis
Web Management – Stellar IT Solutions

2010–2011

Executive Director – Terri K. Belcher
Annual Conference Housing Bureau – Wyndham Jade
Journal Technical Editor – Bonnie Katz
Member & Conference Services – Association, Conferences & Exhibition Management, Inc.
Newsletter Technical Editor – Deborah Anker, BesType
Technology Liaison – Charlene Chausis
Web Management – Stellar IT Solutions

Request for Nominations

2011 NCSM Board Positions

The following positions are open for the 2011 Board:

Second Vice President
Regional Director, Central 2
Regional Director, Eastern 2
Regional Director, Western 2

Visit mathedleadership.org for details about the positions, the nomination procedure, and the nomination form.

The deadline for nominations for the NCSM Board positions is Friday, May 14, 2010.

Request for Speaker Proposals

43rd NCSM Annual Conference Indianapolis, Indiana April 11-13, 2010

Theme: *On Track for Student Success: Mathematics Leaders Making a Difference*

Strands:

As leaders in mathematics education, we are charged with supporting teachers to provide all students access to a high quality mathematics program. To this end, the 2011 NCSM Annual Conference will provide sessions that enhance our work as mathematics leaders. We invite proposals that focus on the follow conference strands:

1. **Assessment of Students/Assessment of Teaching** – Share how you help teachers develop the knowledge and skills necessary to ensure accurate monitoring of student learning and adjustment of teacher instruction for every student on a daily basis.
2. **Developing Coaches/Developing Teachers** – Share how you support and encourage teachers and help them develop strategies to enhance mathematics teaching and learning in their classrooms.
3. **Teaching & Learning**
 - Curriculum for Students/Curriculum for Teachers
 - Equity
 - Differentiated Instruction

Share strategies for helping teachers develop the knowledge and skills necessary to ensure high-level, relevant, and meaningful mathematics in every lesson and provide access to that mathematics for every student.

4. **STEM (Science, Technology, Engineering, & Mathematics)** – President Obama has announced a campaign to enlist companies and nonprofit groups to spend money, time, and volunteer effort to encourage students, especially in middle and high school, to pursue science, technology, engineering, and mathematics. Share how you are educating to innovate.

All speaker proposals must be submitted online at mathedleadership.org.

The deadline for submission of speaker proposals is June 7, 2010.

NCSM Grants, Awards, Certificates

Support the NCSM Iris Carl Leadership Fund

The NCSM Iris Carl Mathematics Leadership Fund endows up to three travel grants per year to NCSM members who have not attended an NCSM conference for the past three years.

The Fund is supported by generous donations from individuals who may mail a check in any amount payable to NCSM Iris Carl Leadership Fund to:

Randy Phippen, NCSM Treasurer
6000E. Evans Ave, #3-205
Denver, CO 80222

Information about the Travel Grant and an application is available on the NCSM Web Site, mathedleadership.org.

Ross Taylor/Glenn Gilbert National Leadership Award

Nominations are open for the 2011 Ross Taylor/Glenn Gilbert National Leadership Award. Any member of NCSM may submit a nomination.

The Ross Taylor/Glenn Gilbert National Leadership Award annually recognizes an individual who has demonstrated leadership in, and has made outstanding, unique, and dedicated contributions to the field of mathematics education.

Award criteria and nomination procedures are available on the NCSM Web Site, mathedleadership.org.

The deadline for nominations for the 2011 award is November 1, 2010.

Student Recognition Certificates

NCSM provides Recognition Certificates as a means of honoring outstanding students who excel in the study of mathematics. All public, parochial, and private schools, colleges, and universities that have at least one NCSM member in the area are eligible to participate. The number of awarded certificates should not exceed two per year per school per graduating class or grade level.

Certificates are available at Conference Registration, or may be ordered from NCSM Member and Conference Services, 6000 E. Evans Ave, #3-205, Denver, CO 80222, (303) 758-9611, office@ncsmonline.org.

More information about the recognition criteria and certificates is available at mathedleadership.org.

Future NCSM Annual Conferences

43rd NCSM Annual Conference

April 11–13, 2011
Indianapolis, Indiana

“On Track for Student Success: Mathematics Leaders Making a Difference”

44th NCSM Annual Conference

April 23–25, 2012
Philadelphia, Pennsylvania

47th NCSM Annual Conference

April 13–15, 2015
Boston, Massachusetts

45th NCSM Annual Conference

April 15–17, 2013
Denver, Colorado

48th NCSM Annual Conference

April 11–13, 2016
San Francisco, California

46th NCSM Annual Conference

April 7–9, 2014
New Orleans, Louisiana

Future NCSM Regional Events

NCSM Regional Events are being planned one day prior to the following NCTM Regional Conferences and Expositions.

See the ad behind the “Wednesday Program” tab or visit mathedleadership.org for details.

2010 NCSM Fall Leadership Seminars

Denver, Colorado
October 6, 2010

Baltimore, Maryland
October 13, 2010

New Orleans, Louisiana
October 27, 2010

2011 NCSM Fall Leadership Seminars

Atlantic City, New Jersey
October 19, 2011

St. Louis, Missouri
October 26, 2011

Albuquerque, New Mexico
November 2, 2011

Also visit mathedleadership.org for NCSM membership events scheduled during the 2010 NCTM Regionals in Denver, Baltimore, and New Orleans. Current and new NCSM members are welcome to participate.

Leadership Academy

14th Annual NCSM Leadership Academy

“Stomping on the Gap!”

Featuring the NCSM PRIME Leadership Framework

June 15–18, 2010
Aurora, Illinois

June 22–25, 2010
Houston, Texas

August 16–19, 2010
New York, New York

See the ad behind the “Monday Program” tab or visit mathedleadership.org for details.

NCSM Publications

NCSM Journal of Mathematics Education Leadership

The editors of the *NCSM Journal of Mathematics Education Leadership* welcome manuscripts that address concerns of leadership in mathematics rather than those of content or delivery. Editors are interested in articles from a broad spectrum of formal and informal leaders who practice at local, regional, national, and international levels.

Categories for submittal include:

- Key Topics in Leadership
- Case Studies
- Research Report and Interpretation
- Commentary on Critical Issues in Mathematics Education
- Professional Development Strategies

Note: The last two categories are intended for short-pieces of 2 or 3 pages in length.

Deadlines for the next two issues are **July 1, 2010**, and **January 1, 2011**.

Submission and review procedures are posted on the NCSM Web Site, mathedleadership.org.

NCSM Newsletter

The *NCSM Newsletter* promotes networking and collaboration among NCSM members and other stakeholders in the education community and welcomes submission from members. The purpose of the *NCSM Newsletter* is to advance the mission and vision of NCSM by informing the membership of the ongoing activities of the NCSM Board, by publishing current information about issues, trends, programs, policy, and practice in mathematics education.

The *NCSM Newsletter* is published four times a year—fall, winter, spring, and summer—and is mailed only to NCSM members as a benefit of membership.

Submission procedures and deadlines are posted on the NCSM Web Site, mathedleadership.org.

Kansky Research Report Summary Service

If you are having a hard time keeping up with reports that analyze, criticize, advise, politicize, and pulverize mathematics and science education and educators, you will find this service of great value.

The Kansky Reports:

- Reduce lengthy reports to 2–4 pages.
- Provide an overview of each report's structure, conclusions and recommendations.
- Identify and briefly describe each report's publisher.
- Provide a web address from which the full report can be downloaded or purchased.

Visit the NCSM Listserv or the NCSM Web Site, mathedleadership.org.

Position Paper Series: Improving Student Achievement

The process of developing research-informed leadership position papers on issues critical to the future mathematics education began in the spring of 2007. Steven Leinwand submitted a proposal to the NCSM Board that described a series of “Advocacy Papers” which provided the template for what would become the NCSM *Improving Student Achievement* Position Paper series. The process for developing each paper begins with identifying an author to create an initial draft on a specific topic. The draft is edited and then sent out to individuals for critique. The paper is revised based on that feedback, returned to the author, and then sent to NCSM’s Board of Directors for review. The paper undergoes a final edit and then is submitted again to the board for approval. The extensive and collaborative process reflects our collective voices and contributes to the power of these position papers.

Recently released Position Papers include:

- *Improving Student Achievement by Leading Effective and Collaborative Teams of Mathematics Teachers* (September 2007)
- *Improving Student Achievement by Leading Sustained Professional Learning for Mathematics Content and Pedagogical Knowledge Development* (September 2007)
- *Improving Student Achievement by Leading the Pursuit of a Vision for Equity* (Spring 2008)
- *Improving Student Achievement in Mathematics for Students with Special Needs* (Summer 2008)
- *Improving Student Achievement by Leading Highly Effective Assessment Practices* (Spring 2009)
- *Improving Student Achievement in Mathematics by Addressing the Needs of English Language Learners* (Fall 2009)

Our thanks and appreciation to all who contributed to this series.

Primary Contributors

Mark Driscoll, Boston, MA

Alfinio Flores, Newark, DE

Linda Fulmore, Cave Creek, AZ

Fred Gross, Newton, MA

Timothy D. Kanold, Chicago, IL

Grace Kelemanik, Boston, MA

Alice Krueger, Centennial, CO

Steve Leinwand, Washington, DC

Suzanne Mitchell, Jacksonville, AR

Kit Norris, Southborough, MA

Janie Zimmer, Reading, PA

Critical Friends/Reviewers

Jim Barta, Salt Lake City, UT

Robert Berry, Charlottesville, VA

Diane J. Briars, Pittsburgh, PA

Randy Charles, Carmel, CA

Grace Coates, Berkeley, CA

Ralph Connelly, Fonthill, ON

Jim Conrey, Lincolnshire, IL

Terry Coes, Wakefield, RI

Marda Cotton-Ramey, Chicago, IL

Jerry Cummins, Hinsdale, IL

Linda Dacey, Cambridge, MA

Arlene Dowshen, Chester, PA

Mark Driscoll, Boston, MA

José Franco, Berkeley, CA

Shirley Frye, Cave Creek, AZ

Kay Gilliland, Oakland, CA

Roberta Girardi, Ellicott City, MD

Carol Greenes, Phoenix, AZ

Rochelle Gutierrez, Champaign, IL

Donna Karsten, Halifax, NS

Henry Kepner, Milwaukee, WI

Lena Licón Khisty, Chicago, IL

Jay Miller, Lincolnshire, IL

Gloria Moran, Braintree, MA

Judit Moschkovich, Santa Cruz, CA

Sara Munshin, Los Angeles, CA

Ileene Paul, Buffalo Grove, IL

Cathy Seeley, Austin, TX

Tod Shockey, Orono, ME

John Sutton, Denver, CO

Fern Tribbey, Northbrook, IL

Steve Tribbey, Northbrook, IL

ANNUAL CONFERENCE COMMITTEES

2009–2010 Conference Planning Committee

San Diego, CA, April 19–21, 2010

Diane J. Briars
NCSM President
Pittsburgh, PA

Cathy Carroll
Conference Coordinator
San Mateo, CA

Linda Fulmore
Program Chair
Cave Creek, AZ

Sandie Gilliam
Volunteer Recruitment and
Management Chair
Colorado Springs, CO

Sara Munshin
Local Support Chair
Los Angeles, CA

Janet Falkowski & Lynn Raith
Sponsor Liaisons
Pittsburgh, PA

Danette Garlock
NCSM Member and Conference
Services Event Coordinator
Denver, CO

Terri K. Belcher
NCSM Executive Director
Berkeley, CA

2010–2011 Conference Planning Committee

Indianapolis, IN, April 11–13, 2011

Diane J. Briars
NCSM President
Pittsburgh, PA

Cathy Carroll
Conference Coordinator
San Mateo, CA

Sandie Gilliam
Program Chair
Colorado Springs, CO

Denise Walston
Volunteer Recruitment and
Management Chair
Chesapeake, VA

Steve Viktora
Local Support Chair
Winnetka, IL

Janet Falkowski & Lynn Raith
Sponsor Liaisons
Pittsburgh, PA

Danette Garlock
NCSM Member and Conference
Services Event Coordinator
Denver, CO

Terri K. Belcher
NCSM Executive Director
Berkeley, CA

NCSM Member and Conference Services

To join NCSM, renew your NCSM membership, and to register for the NCSM Annual Conference, Regional Events and Leadership Academy, contact:

NCSM Member and Conference Services
6000 E. Evans Ave, #3-205
Denver, CO 80222
Phone: (303) 758-9611 Fax: (303) 758-9616
office@mathedleadership.org

2009–2010 Sponsor Partners

NCSM gratefully acknowledges the generous support and contributions made by the following companies to the 43rd NCSM Annual Conference and/or various NCSM activities throughout the year. All NCSM members and conference attendees are encouraged to express their appreciation to each company through the contacts indicated below.

America's Choice

Annual Conference Wednesday Breakfast and NCSM Regional Leadership Seminars Lunches

America's Choice
1919 M Street NW, Suite 310
Washington DC 20036
Website: www.americaschoice.org

Cindy Fielder

Director of Mathematics
(678) 361-4397
cfielder@americaschoice.org

Kevin Feimster

Staff Operations Manager
(202) 783-3668 x2207
kfeimster@americaschoice.org

Clifton D. Crump

Marketing Coordinator
(646) 943-8125
ccrump@americaschoice.org

CASIO America, Inc.

Annual Conference Wednesday Luncheon with Houghton Mifflin Harcourt

CASIO America, Inc
570 Mt. Pleasant Avenue
Dover, NJ 07801
Website: www.casioeducation.com

Matt Weiss

*General Manager, Consumer
Products Division*
(973) 361-5400 x 1561
mweiss@casio.com

Greg Yurchuk

*Director of Marketing, Education
Division*
(973) 361-5400 x 1146
gyurchuk@casio.com

James A. "Mitch" Mitchell

*National Business Development
Manager*
10603 Westwood Drive
Cheltenham, MD 20623
(301) 372-8800
jmitchell@casio.com

CORD Communications, Inc.

Annual Conference Program Brochure and Annual Conference Program Book

CORD Communications, Inc.
601 Lake Air Drive
Waco, TX 76710
Website:
www.cordcommunications.com

Piers Bateman

President and CEO
(254) 776-1822 x 327
pbateman@cordcommunications.com

Claudia Maness

National Implementation Manager
(254) 776-1822 x 371
cdmaness@cordcommunications.com

R. Darin Brock

Director of Marketing
(254) 776-1822 x 313
dbrock@cordcommunications.com

Didax

Annual Conference Monday Box Lunch

Didax Education
395 Main Street
Rowley, MA 01969
Phone: (800) 458-0024
Fax: (800) 350-2345
Website: www.didax.com

Brian Scarlett

President
(978) 997-4310
brian@didax.com

Steve Lanza

Vice President, Development
(978) 997-4395
steve@didax.com

Margo Hanson

Marketing Manager
(978) 997-4385
margo@didax.com

EAI Education

Travel Alarm Clock

EAI Education
118 Bauer Drive
P.O. Box 7046
Oakland NJ 07436-7046
Phone: (800) 770-8010
Email: info@eaieducation.com
Website: www.eaieducation.com

Bernard Guglberger

National Sales Manager
(800) 770-8010
bguglberger@eaiusa.com

Barbara Tuzzeo

Sales Manager
(800) 770-8010 x 7600
btuzzeo@eaiusa.com

Educators Outlet

Annual Conference Signage and Luggage Tags

Educators Outlet, Inc.
P.O. Box 397
Timnath CO 80547
Website: www.educatorsoutlet.com

Gary Otto

Vice President, Business Development
(800) 315-2212
garyotto@educatorsoutlet.com

Robert Bond

President
(970) 224-3811
rbond@educatorsoutlet.com

Blake Lilley

Exhibit Coordinator
(970) 224-3811 x223
blakelilley@educatorsoutlet.com

Encyclopaedia Britannica

Annual Conference Cyber Café

Britannica Digital Learning /
Encyclopaedia Britannica Inc.
331 North La Salle St
Chicago IL 60654
Phone: (800) 621-3900
Website: info.eb.com

Trina Williams

Mathematics Director
(800) 621-3900 x7069
twilliams@eb.com

Paul Ridgway
Associate Director of Mathematics
(800) 621-3900 x7049
pridgway@eb.com

Crystal deHaven
Exhibits Manager
(800) 621-3900 x7051
cdehaven@eb.com

ETA/Cuisenaire

Annual Conference Mug, Leadership Academy, and Marketing Support

ETA/Cuisenaire
500 Greenview Court
Vernon Hills, IL 60061
Website: www.etaquisenaire.com

Sara Delano Moore
Director of Mathematics and Science
(300) 619-0119
smoore@etaquisenaire.com

ExploreLearning

Annual Conference Signage, Magnetic Refrigerator Clip, and Regional Seminar Support

ExploreLearning
P.O. Box 2185
Charlottesville, VA 22902
Website: www.explorelearning.com

Rick Roegiers
National Sales Director
(866) 882-4141 x 207
rroegiers@explorelearning.com

Julia Given
Marketing Director
(434) 293-7043 x 223
jgiven@explorelearning.com

David Shuster
Founder and Publisher
(434) 293-7043 x 222
dshuster@explorelearning.com

Houghton Mifflin Harcourt

Annual Conference Wednesday Luncheon with CASIO America, Inc. and Leadership Academy Support

Houghton Mifflin Company
222 Berkeley St
Boston MA 02116
Website: www.hmhpublish.com

Michal-Lynn Jakala
Meetings and Exhibit Manager
(815) 230-5650
ML.Jakala@hmhpublish.com

Linda Peeler
Senior Product Manager, Elementary Mathematics
(803) 808-8211
Linda.Peeler@hmhpublish.com

Marta Miko
Product Manager, Elementary Mathematics
(617) 351-3844
Marta.Miko@hmhpublish.com

Katie Leszczynski
Associate Product Manager, Elementary Mathematics
(617) 351-5461
Katie.Leszczynski@hmhpublish.com

Mary Connolly
Vice President, Elementary and Supplementary Materials Portfolio Manager
(617) 351-5262
mary.connolly@hmhpublish.com

It's About Time, Herff Jones Education Division

Annual Conference Media Production

It's About Time, Herff Jones Education Division
84 Business Park Dr, Ste 307
Armonk NY 10504
(888) 698-TIME
Fax: (914) 206-6444
Email: generalinfo@herffjones.com
Website: www.its-about-time.com

Tom A. Laster
President
(914) 273-2233 x 501
talaster@herffjones.com

John Nordland
Creative Director
(914) 273-2233 x 515
jrnordland@herffjones.com

Barbara Zahm
Executive Vice President
Director of Product Development and Grant
(914) 273-2233 x 520
bzahm@herffjones.com

Martha Katechis
Conference Coordinator
(888) 698-8463
(914) 273-2233 X529
mdkatechis@herffjones.com

Key Curriculum Press NCSM Office Services and Space

Key Curriculum Press
1150 65th St
Emeryville CA 94608
Website: www.keypress.com

Afiya Bala
Events Coordinator
(510) 595-7000 x149
abala@keypress.com

Jim Ryan
Vice President, Marketing
(800) 995-MATH x 249
jryan@keypress.com

The Math Forum @ Drexel NCSM Website, Listserv and Email Hosting

The Math Forum @ Drexel
3210 Cherry St
Philadelphia PA 19104
Website: mathforum.org

Stephen Weimar
Director
(215) 895-1080
stephen@mathforum.org

Amir Tahvildaran
Supervisor, Software Operations
(215) 895-1080
amir@mathforum.org

Math Solutions

Annual Conference Literary Gift: Faster Isn't Smarter by Cathy Seeley

Math Solutions
150 Gate 5 Rd
Sausalito CA 94965
(800) 868-9092
Email: info@mathsolutions.com
Website: www.mathsolutions.com

Tracy Kleine
Marketing Manager
(415) 339-4819
tkleine@mathsolutions.com

Carolyn Felux
Education Director
647 E Nottingham Place
San Antonio, TX 78209
(210) 829-0300
cfelux@mathsolutions.com

**McGraw-Hill School
Education Group
NCSM Membership Scholarships and
Leadership Academy Support**

**McGraw-Hill School Education
Group**

8787 Orion Pl
Columbus OH 43240
Website: www.mheducation.com

Donna Long

*Elementary Mathematics Marketing
Manager,*
(614) 430-6346
donna_long@mcgraw-hill.com

MIND Research Institute

**Annual Conference Monday
Continental Breakfast**

MIND Research Institute

3631 S. Harbor Boulevard, Suite 200
Santa Ana, CA 92704
Phone: (888) 751-5443
Website: www.mindresearch.net

Ingrid Ellerbe

Vice President of Marketing
(714) 751-5443
iellerbe@mindresearch.net

Rob Magliano

Director of Sales, Eastern Region
(610) 551-9818
rmagliano@mindresearch.net

Pearson

**Annual Conference Tuesday Reception
and Conference Bags**

Pearson

One Lake St
Upper Saddle River NJ 07458
Website: www.PearsonSchool.com

Mike Evans

SVP, Mathematics
Pearson
1900 E Lake Ave
Glenview IL 60025
(847) 486-2104
mike.evans@pearson.com

John Carroll

Vice President, Mathematics
Pearson
501 Boylston St
Boston MA 02116
(617) 671-2041
john.carroll@pearson.com

Denise O'Dea

Event Specialist, Curriculum Group
One Lake Street
Upper Saddle River, NJ 07458
(201) 236-6613
denise.odea@pearson.com

Texas Instruments

**Annual Conference Tuesday Luncheon
and NCSM Membership Brochure**

Texas Instruments

Education Technology Group
P.O. Box 650311
Dallas, TX 75265
Website: education.ti.com

Melendy Lovett

*President, Education Technology
Group*
Senior Vice President, Texas
Instruments
mlovett@ti.com

Jamie Alexander

Manager, Exhibits & Events Group
(214) 567-5682
jalexander@ti.com

Karen Dalton

Exhibit Coordinator
(972) 917-1541
kdalton@ti.com

Mark Frye

*Senior Consultant, Conferences,
Meetings and Events*
(972) 917-2061
frye@ti.com

**Tom Snyder Productions, A
Scholastic Company**

**Annual Conference Tuesday Breakfast
and Conference Neck Wallets**

**Tom Snyder Productions, a
Scholastic Company**

100 Talcott Ave
Watertown, MA 02472
Website: tomsnyder.com

Peter Cipkowski

*Vice President, Mathematics
Marketing*
(617) 926-6000
pcipkowski@tomsnyder.com

2010 Guide to Advertisers

Advertiser	Location
America's Choice	Behind Monday program tab
Borenson and Associates, Inc.	Behind Monday program tab
CASIO America, Inc.	Behind Wednesday program tab
CORD Communications, Inc.	Behind About NCSM tab
Educators Outlet	Outside back cover
Encyclopaedia Britannica	Behind Tuesday program tab
ETA/Cuisenaire	Behind Tuesday program tab
Exemplars	Page 47
ExploreLearning	Inside front cover
Heinemann Publishing	Behind Wednesday program tab Behind About NCSM tab
Key Curriculum Press	Inside back cover
The Math Forum @ Drexel	Behind Wednesday program tab
Math Solutions	Behind Wednesday program tab
McGraw-Hill School Education Group	Behind Tuesday program tab
MIND Research Institute	Behind About NCSM tab
Scholastic	Behind Monday program tab Behind Wednesday program tab Behind About NCSM tab
Texas Instruments	Behind Monday program tab

Sponsor Showcase Sessions

All Sponsor Showcase Sessions will be held in Annie on the 3rd Floor.

Monday

9:30 AM – 10:30 AM	It's About Time , Session 112: It's About Time to Level the Playing Field: Low Performing Students Can Succeed!
10:45 AM – 11:45 AM	MIND Research Institute , Session 129: Automaticity WITH Understanding
12:15 PM – 1:15 PM	Key Curriculum Press , Session 145: Ignite NCSM! Ten Speakers Light Up the Room with Fresh Ideas in Mathematics.
1:30 PM – 2:30 PM	Houghton Mifflin Harcourt , Session 155: Singapore Math for the US Classroom
2:45 PM – 3:45 PM	CASIO America, Inc. , Session 165: CASIO Technology at Work – Building 21 st Century Skills

Tuesday

8:45 AM – 9:45 AM	Math Solutions , Session 211: Helping Teachers Help Children Build Mental Math and Computation Strategies
10:15 AM – 11:15 AM	ETA/Cuisenaire , Session 227: Comprehensive Solutions for Algebra Success
2:45 PM – 3:45 PM	Pearson , Session 250: Changing the Way Students See and Learn High School Math

Wednesday

8:45 AM – 9:45 AM	Tom Snyder Scholastic Productions , Session 310: Critical Foundations for Algebra: Implications for Intervention
10:00 AM – 11:00 AM	Texas Instruments , Session 325: Changing Opportunities and Changing Lives by Moving Math Forward
11:15 AM – 12:15 AM	America's Choice , Session 340: The Common Core Standards: Getting Ahead of the Curve for Implementation

Technology Showcase Sessions

All Technology Showcases will be held in Emma on the 3rd Floor.

Monday

9:30 AM – 10:30 AM	Agile Mind , Session 111: Using Technology for Student Success in 6–12 Mathematics
10:45 AM – 11:45 AM	Didax , Session 128: Improve Student Performance with Kathy Richardson's K-3 Formative Assessment
12:15 PM – 1:15 PM	Texas Instruments , Session 144: TI's Interactive Math Classroom Fresno Site: Year Two Report and Hands-On Demonstration Lab
1:30 PM – 2:30 PM	Encyclopedia Britannica , Session 154: Practice SMART! Assess SMART! Differentiate SMART! <i>Britannica SmartMath!</i>
2:45 PM – 3:45 PM	Math Solutions , Session 164: Math Solutions Technology Showcase: Introducing ePD™ Coaching , An Interactive Coaching Service
4:00 PM – 5:00 PM	Key Curriculum Press , Session 180: Sketchpad and Elementary Math: The Key to Improving Student Learning and Engagement

Tuesday

8:45 AM – 9:45 AM	Carnegie Learning, Inc. , Session 210: Launch of Carnegie Learning's New Geometry Curriculum Featuring the Cognitive Tutor Proof Tool
10:15 AM – 11:15 AM	CASIO America, Inc. , Session 226: Do You Speak "CASIO"?
2:45 PM – 3:45 PM	ExploreLearning , Session 249: Using Online Simulations to Catalyze Better Math Instruction

Index of All Speakers

Speaker	Session				
Adams, Thomasenia Lott	232	Davenport, Linda	103	Hakansson, Susie	242
Alejandre, Suzanne	109	Davis, Thelma	176	Hamada, Lori	130
Andreana, Diane	123	Davis, Donna	233	Haney, Paula	325
Askey, Richard	230	Delaney, Barbara	109	Hanson, Margo	128
Azin, Mariam	336	Dempsey, Nan	115	Harbin Miles, Ruth	122
Ball, Deborah Loewenberg	332	Dhaliwal, Jivan	242	Harding-Dekam, Jenni	334
Balka, Don	122	Dick, Tom	217	Hedges, Melissa	246, 305
Bannister, Nicole	178	Dillender, Cathie A.	250	Heid, M. Kathleen	322
Barta, Jim	334	Dixon, Amber	150	Heidema, Clare	147
Bartle, Sandy	210	Dixon, Juli	341	Heikkinen, Susan	175
Bastable, Virginia	133, 213	Dockterman, David	201	Hern, Meghan	334
Bay-Williams, Jennifer	327	Douglas, Cindy	218	Hidalgo, Paula	164
Beckmann, Sybilla	125	Driscoll, Mark	238	Hill, Polly	311
Beckmann, Charlene	308	Duckhorn, Patricia	242	Hogan, Marie	109
Bedford, Pandora	140, 305	Dyson, Sally	231	Hoover, Murrel	339
Beecham, Jamie	245	Echols, Cherie	174	Howard, Tyrone	202
Berridge, Carol	153	Economopoulos, Karen	157, 228	Howard, Lorraine	345
Bezuk, Nadine	352	Edmonds, Robin	123	Huber, Leigh	134
Bicer, Alpay	118	Ellington, Roni	345	Huinker, DeAnn	152
Birnie, Susan	255	Euretig, Mary	153	Hull, Susan	111, 344
Bitter, Gary	118	Fagan, Emily	216, 347	Hull, Ted	122
Board, Jill	302	Fantz, Traci	171	Hwee, Lim Soke	224
Bohan, Jim	138	Felux, Carolyn	164, 211	Jackson, Shelia	156
Bohan, Susan	330	Fennell, Francis (Skip)	105	Jacobs, Vicki	170
Bonner, Emily	232	Fetter, Annie	247	Jain, Darshan	318
Boswell, Laurie	257	Findell, Brad	342	Jitendra, Asha	107
Bradley, Janice	110	Fletcher, Jennifer	245	Joyner, Jeane	206
Bradsby, Larry	121, 251, 309	Flores, Alfinio	317	Kalman, Richard	355
Briars, Diane	146, 181, 243	Fong, Ho-Kheong	224	Kanim, Kathe	110
Brodesky, Amy	216, 306, 347	Fonzi, Judi	151	Kanold, Timothy	136, 205
Brown, Cathy	131	Foreman, Linda	302	Kanter, Patsy	155
Bryson, Janet	314	Foresman, Guy	162	Karp, Karen	327
Bunt, Nancy	148	Foster, David	172, 349	Karsten, Donna	252
Burgess, Michele	235	Franco, José	343	Kearns, James	112
Burns, Marilyn	244	Freeman, Marji	164, 223	Kelso, Catherine	236
Burrill, Gail	108, 217	Frye, Shirley	121	Kendall, Monica	209
Callard, Cindy	151	Fuson, Karen	125, 335	Kendrick, Diana	254
Cameron, Antonia	166, 231	Gartzman, Martin	344	Kepner, Hank	241
Cannon, Marilyn	328	Gates, Claire	169, 171	Kerins, Bowen	143
Carman, Elaine	233	Gavin, M. Katherine	356	Kilian, Joy	158
Catanzaro, Linda	237	Gianneschi, Stephanie	174	Kinch, Diane	135
Cavanaugh, Mary	179	Giberson, Nancy	101	King, Jim	178
Charischak, Ihor	351	Gilbert, Barbara	163	Kise, Jane	167
Charles, Randall	336	Gilbert, Michael	163	Kniel, Leslie	311
Cheng, Ivan	127	Gillespie, Jane	144	Kobett, Beth	105
Clark, Andy	155, 159	Gilliam, Sandie	117, 261	Kranendonk, Henry	152
Clements, Douglas	125	Ginsburg, Herb	125, 331	Kysh, Judy	323
Coates, Grace	229	Girard, Nina	141	Lahey, Jennifer	117
Coates, Grace Dávila	329	Gojak, Linda	121, 222	Lamb, Lisa	170
Cochran, Keith	157, 228	Gonzales, Roseanna	245	Lappan, Glenda	161
Coe, Karen	145	Gorman, Jane	312, 354	Larkin, Tanya	110
Coggins, Debra	329	Greenburg, Robert	214	Lavelle, Lisa	169
Collar, Betsy	174	Greenes, Carole	121, 179	Lawrence, Paul	338
Cook, Kathi	111	Greenhaus, Karen	180	Leimberer, Jennifer	236
Cummins, Jerry	121	Griffin, Linda	106	Leinwand, Steve	121, 220
Cuoco, Al	143	Gross, Fred	306, 347	Leonard, Jacqueline	345
Daro, Phil	301, 340	Gummer, Edith	171	Ley, John	313
		Haake, Jan	116	Linnenburger, Jim	311

Lovett, Melendy	234	Rahming, Bernard	140	Veater, Carl	144
Lynch, Monique	337	Ramirez, Nora	343	Viktora, Steve	253
Malian, Ida	179	Reed, Kristen	160	Walker, Cathy	339
Maly, Laura	316	Resek, Diane	323	Wang-Iverson, Patsy	230
Mangin, Melinda	204	Restivo, Serena	158	Webb, David	114
Marchillo, Joanie	246	Reys, Barbara	221, 352	Weissglass, Julian	120, 168
Marsh, Georganne	215	Richardson, Kathy	128, 153	Weksler, David	351
Martin, Cathy	203	Ridgway, Paul	154	West, Lucy	166
Martin, Gary	208	Robarge, Jamie	245	Williams, James	150
Martin, Terry	319	Roschelle, Jeremy	234, 326	Williams, James	340
Mawhinney, Katherine	206, 207	Rosowski, Arlene	150	Williams, Trina	154
Mayfield-Ingram, Karen	229	Rowan, Tom	121	Wilson, Patricia	322
McCormick, Alison	134	Russell, Susan Jo	213	Winicki-Landman, Greisy	135
McGlone, Chadd	334	Salmons, Amy	339	Wong, Khoon Yoong	326
McLemore Salinas, Tracie	207	Sammons, Kay	105	Woodward, John	107
Mead, Claire	142	San Juan, Kristen	325	Wray, John	105
Mesplé, Lisa	113	Sanders, Lisa	158	Yeap, Ban Har	326
Meylani, Rusen	118	Schefelker, Beth	246, 305	Zarach, Nancy	124
Miller, Ashley	109	Schexnayder, Juli	307	Zimmermann, Gwen	318
Miller, Winnie	131	Schifter, Deborah	133, 213		
Miller, Andrea	235	Schmit, Peter	176		
Milou, Eric	177	Schmoker, Mike	102		
Mitchell, Suzanne	137, 258	Schrock, Connie	248, 256		
Mitchell, Arlene	147	Scott, Kwame Anthony	303		
Mooney, Mary	316	Seago, Nanette	238		
Moore, Sara Delano	227	Seeley, Cathy	149		
Moore, Doug	331	Seitz, Richard	259		
Morse, Amy	333	Sgarlotti, Richard	346		
Mosesson-Teig, Carol	231	Shaneyfelt, Sam	173		
Moyer, Eric	214	Shanughnessy, Mike	302		
Munshin, Sara	260	Sheffield, Linda	321, 356		
Murawski, Corinne	148	Siegfried, John (Zig)	170		
Murray, Karen	158	Silverman, Fredrick "Rick"	346		
Myren, Christina	320	Simpson, Bob	319		
Navarra, Agustin	240	Simpson Leak, Donna	104		
Nelson, Barbara	160	Slabic, Stephanie	231		
Neral, John	225, 226	Slover, Laura	324, 342		
Neuse, Kay	165	Small, Marian	126		
Nikula, Johannah	238	Smith, Patty	239		
Norris, Kit	137, 212, 348	Smith, Margaret	315		
O'Brien, Thom	249	Spinos, Jennifer	176		
O'Clair, Kris	203	Star, Jon	107		
Olson, Judith	163	Stoelinga, Sara	204		
Olson, Melfried	163	Stoelinga, Timothy	215		
Paek, Pamela	219	Storeygard, Judy	320		
Palumbo, Marian	230	Strong, Dorothy	121		
Papakonstantinou, Anne	209	Suddreth, Diana	304		
Parker, Ruth	113	Sutton, John	147		
Parr, Richard	209	Swarthout, Mary	330		
Parrish, Sherry	211	Sykes, Debra	150		
Patton, Charles	326	Tamler, Louis	350		
Peterson, Matthew	129	Tassell, Janet	321		
Philipp, Randolph	170	Taylor-Cox, Jennifer	132		
Phillips, Elizabeth	161	Thompson, Denisse	308		
Pippen, Randy	243	Tinto, Patricia	124		
Pitvorec, Kathleen	116	Toncheff, Mona	175, 307, 353		
Pordum, Rebecca	123	Toolson, Deborah	179		
Porras, Gilda	153	Trow, Marilyn	310		
Quander, Judith	208	Usiskin, Zalman	139		
Quisenberry, Tanya	110	Usnick, Virginia	176		

Index of Presiders

Birnie, Susan	202
Boswell, Laurie	136
Connelly, Ralph	156
Fulmore, Linda	102
Gojak, Linda	241
Kanold, Timothy	218
Karsten, Donna	146
Kendrick, Diana	172
Mitchell, Suzanne	332
Munshin, Sara	120
Schrock, Connie	302
Seitz, Richard	103
Viktora, Steven	317

Lead Speaker Contact Information

Adams, Thomasenia Lott
tla@coe.ufl.edu

Alejandre, Suzanne
suzanne@mathforum.org

Andreana, Diane
dandreana@buffaloschools.org

Ball, Deborah Loewenberg
dball@umich.edu

Bartle, Sandy
aweight@carnegielearning.com

Bastable, Virginia
vbastabl@mtholyoke.edu

Bay-Williams, Jennifer
jmbayw01@louisville.edu

Bedford, Pandora
bedfordpd@milwaukee.k12.wi.us

Bezuk, Nadine
nbezuk@mail.sdsu.edu

Birnie, Susan
sbirnie@acps.k12.va.us

Bohan, Jim
jim_bohan@iu13.org

Boswell, Laurie
laboswell@gmail.com

Bradley, Janice
jbradley@nmsu.edu

Bradsby, Larry D.
lsbradsby@hotmail.com

Briars, Diane J.
djbmath@comcast.net

Brodesky, Amy
abrodesky@edc.org

Brown, Cathy
tips4cathybrown@gmail.com

Bryson, Janet
janet@explearn.com

Bunt, Nancy R.
nancy.bunt@aiu3.net

Burgess, Michele
michele.burgess@aiu3.net

Burns, Marilyn
mburns@mathsolutions.com

Burrill, Gail
burrill@msu.edu

Cameron, Antonia Marie
tonicam2@aol.com

Cannon, Marilyn D.
marilyn.cannon@raytownschools.org

Carman, Elaine M.
ecarman@schools.nyc.gov

Catanzaro, Linda
lcatanzaro@mindresearch.net

Charischak, Ihor
Tamler@Cityhigh.org

Charles, Randall
rcharles155@me.com

Cheng, Ivan
icheng@csun.edu

Clark, Andy
andyclark@qwest.net

Clements, Douglas H.
clements@buffalo.edu

Cochran, Keith
keith_cochran@terc.edu

Coe, Karen
kcoe@keypress.com

Coggins, Debra
dcoggins@comcast.net

Cook, Kathi
klcook@mail.utexas.edu

Cuoco, Al
acuoco@edc.org

Daro, Phil
pdaro@americaschoice.org

Davenport, Linda
ldavenport@boston.k12.ma.us

Davis, Thelma
thelmadavis2@cox.net

Dempsey, Nan
dempseyn@scsc.edu

Dick, Tom
tpdick@math.oregon.edu

Dillender, Cathie A.
cathie.dillender@pearson.com

Dixon, Juli K.
jkdixon@mail.ucf.edu

Dockterman, David
dock@tomsnyder.com

Douglas, Cindy
cdouglas@guhdsd.net

Economopoulos, Karen
karen_economopoulos@terc.edu

Felux, Carolyn
cfelux@mathsolutions.com

Fennell, Francis (Skip)
ffennell@mcdaniel.edu

Fetter, Annie
annie@mathforum.org

Flores, Alfinio
alfinio@math.udel.edu

Fong, Ho-Kheong
dr.hkfong@gmail.com

Fonzi, Judi
Judith.fonzi@rochester.edu

Foresman, Guy
drforesman@cox.net

Foster, David
dfoster@svmimac.org

Freeman, Marji Ann
mfreeman@mathsolutions.com

Fuson, Karen C.
fuson@northwestern.edu

Gartzman, Martin
gartzman@uic.edu

Gianneschi, Stephanie
ssgianneschi@aps.k12.co.us

Giberson, Nancy
giberson@sdcoe.net

Gilliam, Sandie
sandie.gilliam@comcast.net

Ginsburg, Herb
hpg4@columbia.edu

Girard, Nina
nina@pitt.edu

Gojak, Linda M.
lgojak@sbcglobal.net

Gonzales, Roseanna RGonzales@pesd92.org	Kanold, Timothy tkanold@d125.org	Mead, Claire claire@mathforum.org
Gorman, Jane jgorman@edc.org	Kanter, Patsy ml.jakala@hnhpub.com	Meylani, Rusen rusen.meylani@asu.edu
Greenes, Carole E. cgreenes@asu.edu	Karsten, Donna karstend@gov.ns.ca	Milou, Eric milou@rowan.edu
Greenhaus, Karen kgreenhaus@keypress.com	Kearns, James mdkatechis@herffjones.com	Mitchell, Suzanne suzmith@comcast.net
Griffin, Linda linda.griffin@educationnorthwest.org	Kelso, Catherine Randall ckelso@uic.edu	Mooney, Mary mooneyme@milwaukee.k12.wi.us
Gross, Fred fgross@edc.org	Kendrick, Diana G. dgtkend@gwmail.gwu.edu	Moore, Sara Delano smoore@etacuisenaire.com
Gummer, Edith gummere@nwrel.org	Kepner, Hank hkepner@nctm.org	Morse, Amy B. amorse@edc.org
Hakansson, Susie W. shakans@ucla.edu	Kinch, Diane diane.kinch@pusd.org	Moyer, Eric eric.x.moyer@pearson.com
Hamada, Lori Michelle lhamada@fcoe.org	King, Jim king@math.washington.edu	Munshin, Sara smunshin@sbcglobal.net
Haney, Paula paula.haney@risd.org	Kise, Jane jane@edcoaching.com	Navarra, Agustin anavarra@cord.org
Hanson, Margo margo@didax.com	Kysh, Judy JudyKysh@gmail.com	Nelson, Barbara S. BNelson@edc.org
Heid, M. Kathleen mkh2@psu.edu	Lavelle, Lisa lisa.lavelle@educationnorthwest.org	Neral, John T. mathguynj300@yahoo.com
Hidalgo, Paula phidalgo@mathsolutions.com	Lawrence, Paul llteach5757670@aol.com	Neuse, Kay kneuse@coppellisd.com
Hill, Polly hillpo@champaignschools.org	Leinwand, Steven J. steveLmath@aol.com	Norris, Kit norriskit@aol.com
Hoover, Murrel murrel.hoover@teachersdg.org	Leonard, Jacqueline jleo@temple.edu	O'Brien, Thom tobrien@explorellearning.com
Howard, Tyrone thoward@gseis.ucla.edu	Ley, John Kevin john@ict4u.com	Olson, Melfried melfried@hawaii.edu
Huber, Leigh leigh.huber@jefferson.kyschools.us	Lynch, Monique C. mlynch@nctm.org	Paek, Pamela L. ppaek@nciea.org
Huinker, DeAnn huinker@uwm.edu	Martin, Cathy A. Cathy_Martin@dpsk12.org	Papakonstantinou, Anne apapa@rice.edu
Hull, Ted H. thhull@mail.utexas.edu	Martin, Gary martiwg@auburn.edu	Parker, Ruth ruthp@mec-math.org
Jackson, Shelia sjackson@sandi.net	Mayfield-Ingram, Karen mayfield@berkeley.edu	Peterson, Matthew iellerbe@mindresearch.net
Joyner, Jeane M. joynerj@meredith.edu	McGlone, Chadd W. cwmcglone@yahoo.com	Philipp, Randolph A. rphilipp@mail.sdsu.edu
Kalman, Richard office@moems.org	McLemore Salinas, Tracie salinastm@appstate.edu	Phillips, Elizabeth A. ephillips@math.msu.edu

Pitvorec, Kathleen kapitvor@uic.edu	Simpson Leak, Donna dsimpsonleak@rich227.org	Weissglass, Julian weissglass@education.ucsb.edu
Rahming, Bernard rahminbv@milwaukee.k12.wi.us	Slover, Laura lslover@achieve.org	West, Lucy lucy@lucywestpd.com
Ramirez, Nora nora.ramirez@asu.edu	Small, Marian marian@unb.ca	Woodward, John woodward@ups.edu
Reys, Barbara reysb@missouri.edu	Smith, Margaret S. pegs@pitt.edu	Zimmermann, Gwen gzimmermann@d125.org
Richardson, Kathy info@mathperspectives.com	Smith, Patty E. saltmath@aol.com	
Ridgway, Paul pridgway@eb.com	Stoelinga, Sara Ray srstoelinga@uchicago.edu	
Roschelle, Jeremy jeremy.roschelle@sri.com	Stoelinga, Timothy M. stoe@uic.edu	
Rosowski, Arlene arosowski@buffaloschools.org	Storeygard, Judy judy_storeygard@terc.edu	
Russell, Susan Jo Susan_Jo_Russell@terc.edu	Suddreth, Diana diana.suddreth@schools.utah.gov	
Sanders, Lisa LSanders@buffaloschools.org	Sutton, John T. sutton@rmcdenver.com	
Schefelker, Beth schefeba@milwaukee.k12.wi.us	Swarthout, Mary B. swarthout@shsu.edu	
Schmoker, Mike schmoker@futureone.com	Tamler, Louis tamler@cityhigh.org	
Schrock, Connie S. cschrock@emporia.edu	Taylor-Cox, Jennifer Jennifer@Taylor-CoxInstruction.com	
Scott, Kwame Anthony mthomba@yahoo.com	Thompson, Denisse R. thompson@tempest.coedu.usf.edu	
Seago, Nanette nseago@wested.org	Tinto, Patricia P. pptinto@syr.edu	
Seeley, Cathy cseeley@mail.utexas.edu	Toncheff, Mona toncheff@phxhs.k12.az.us	
Seitz, Richard ottoseitz@hotmail.com	Trow, Marilyn mtrow@scholastic.com	
Shaneyfelt, Sam R. samuel.shaneyfelt@aiu3.net	Usiskin, Zalman z-usiskin@uchicago.edu	
Shaughnessy, Mike mikesh@pdx.edu	Veater, Carl cveater@fcoe.org	
Sheffield, Linda Jensen sheffield@nku.edu	Viktora, Steve viktoras@newtrier.k12.il.us	
Silverman, Fredrick "Rick" L. flsilver@gmail.com	Wang-Iverson, Patsy pwangiverson@gmail.com	
Simpson, Bob bob@naiahedc.org	Webb, David C. dcwebb@colorado.edu	

Sponsor Display Area

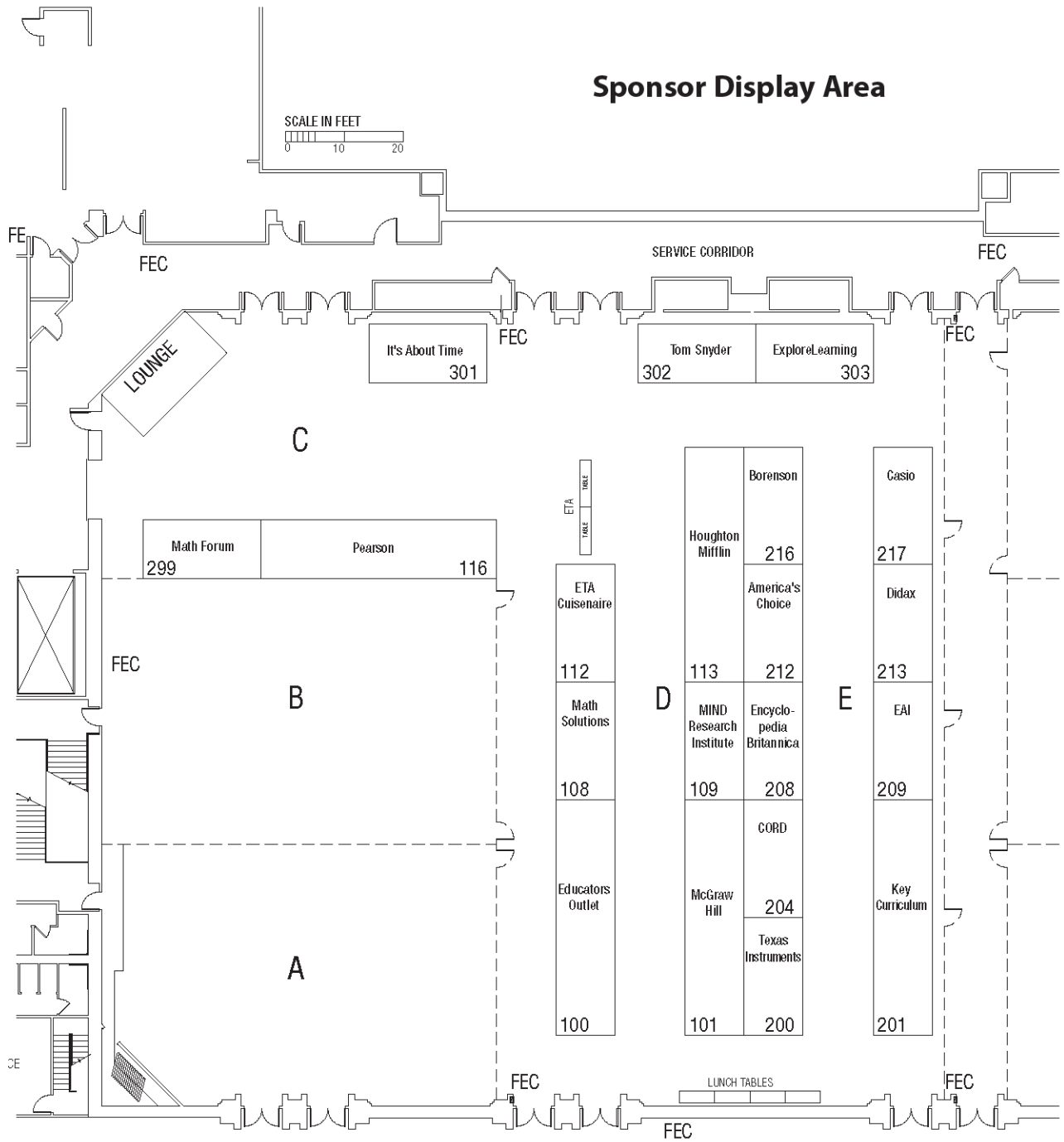

Manchester Grand Hyatt—Ground Level

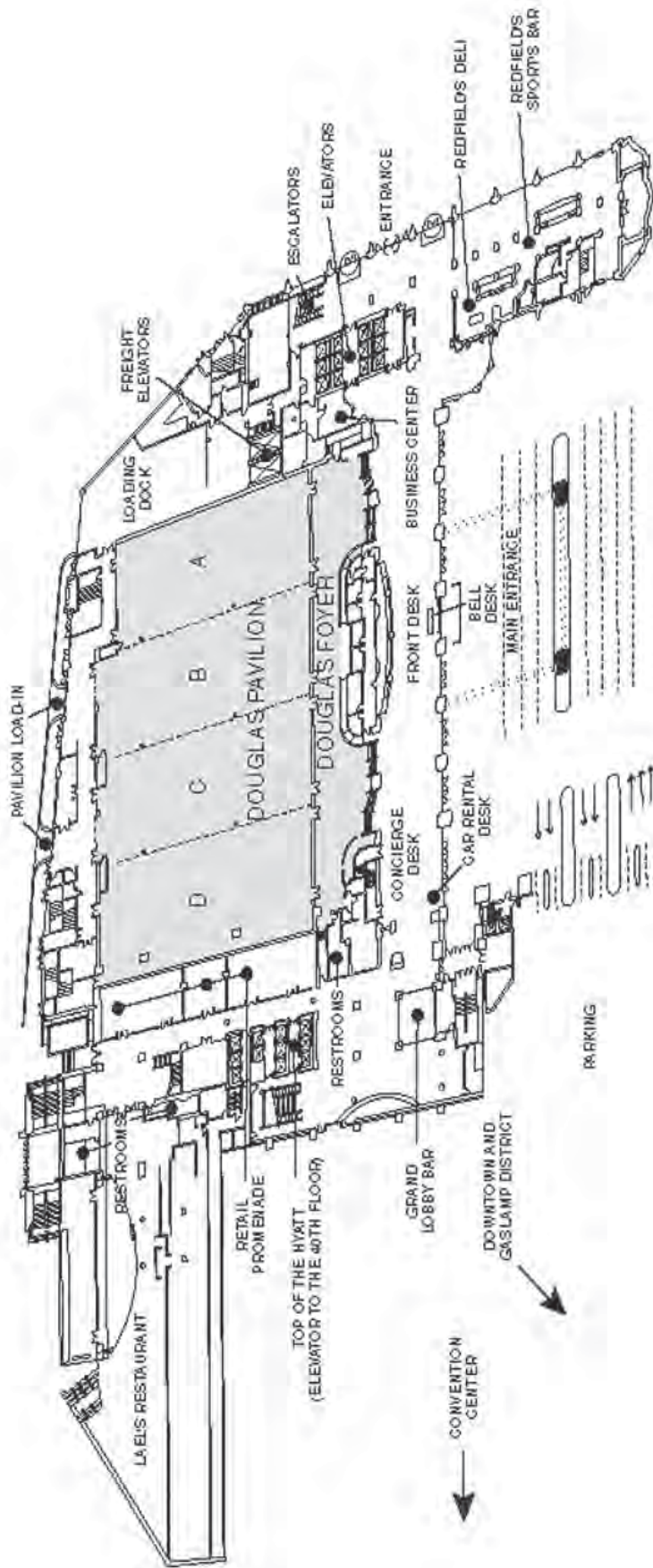

Manchester Grand Hyatt—Second Level

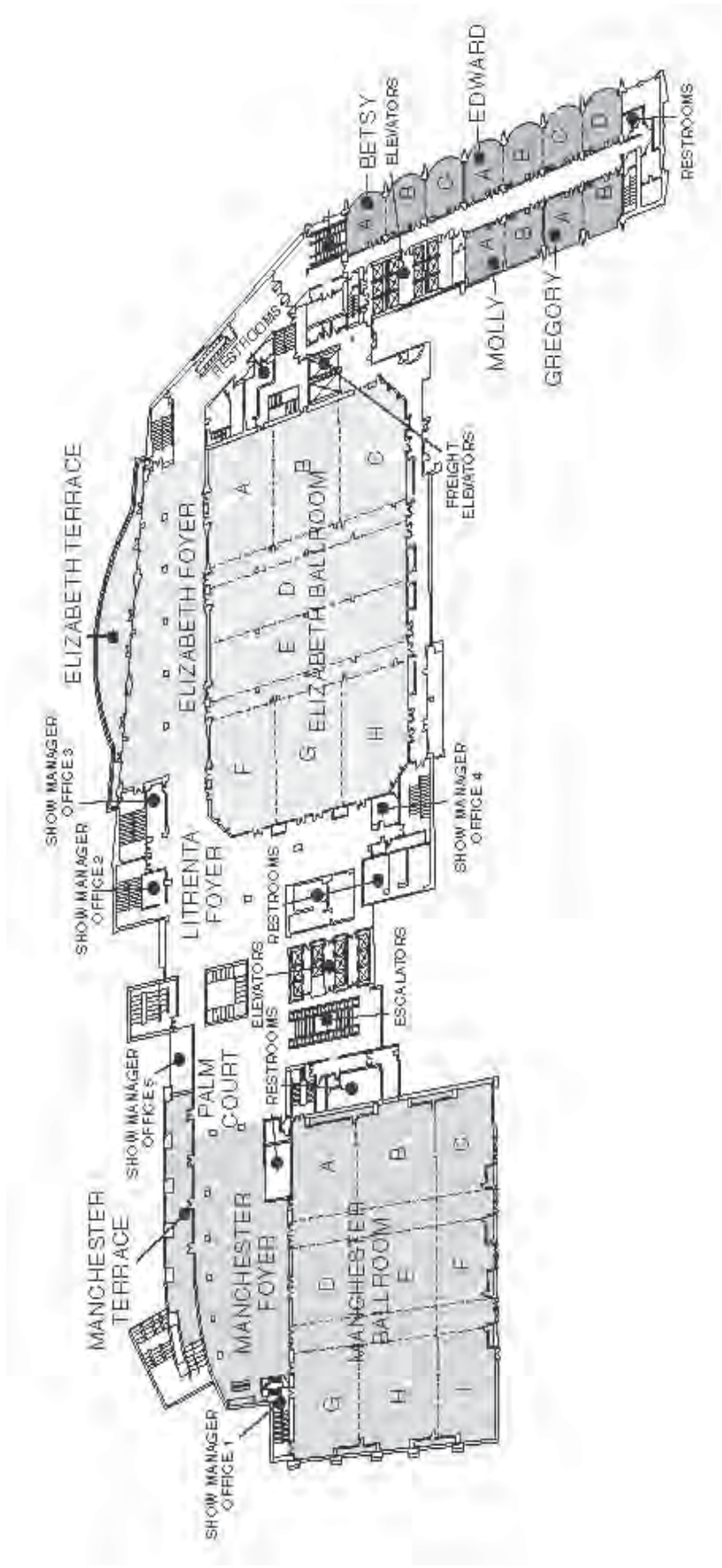

Manchester Grand Hyatt—Third Level

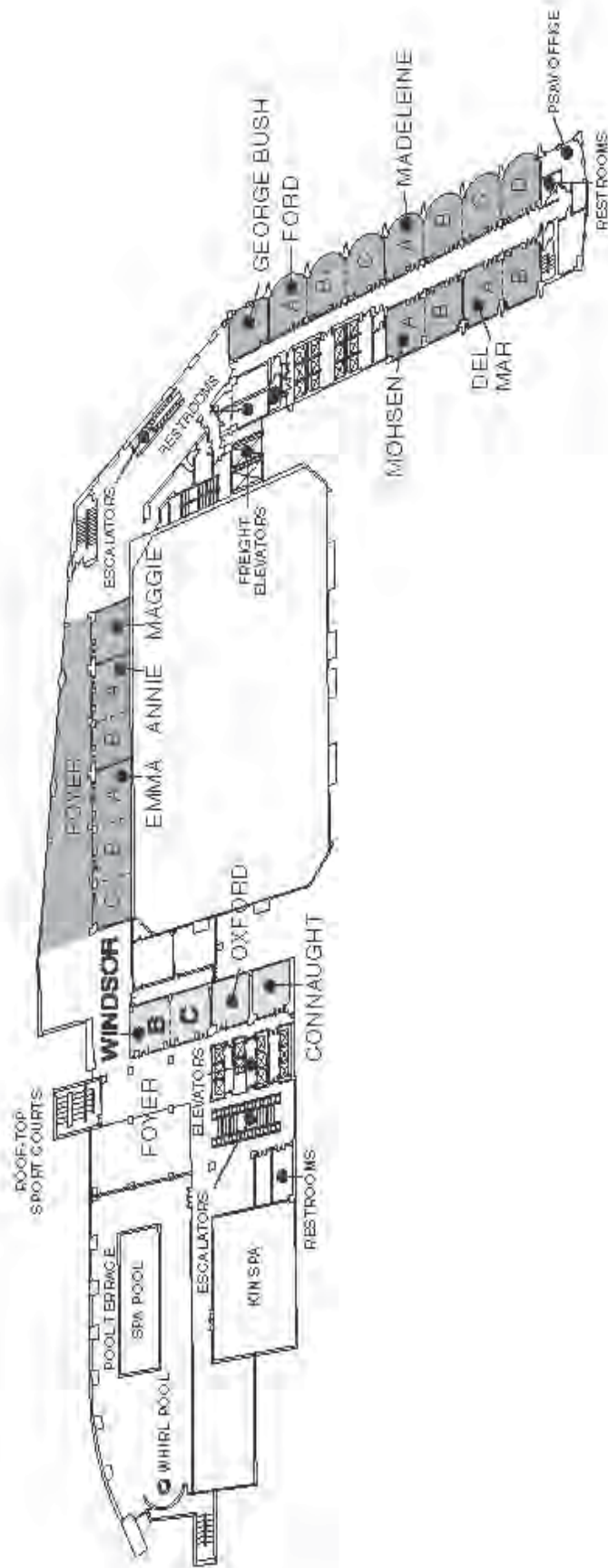

Manchester Grand Hyatt—Fourth Level

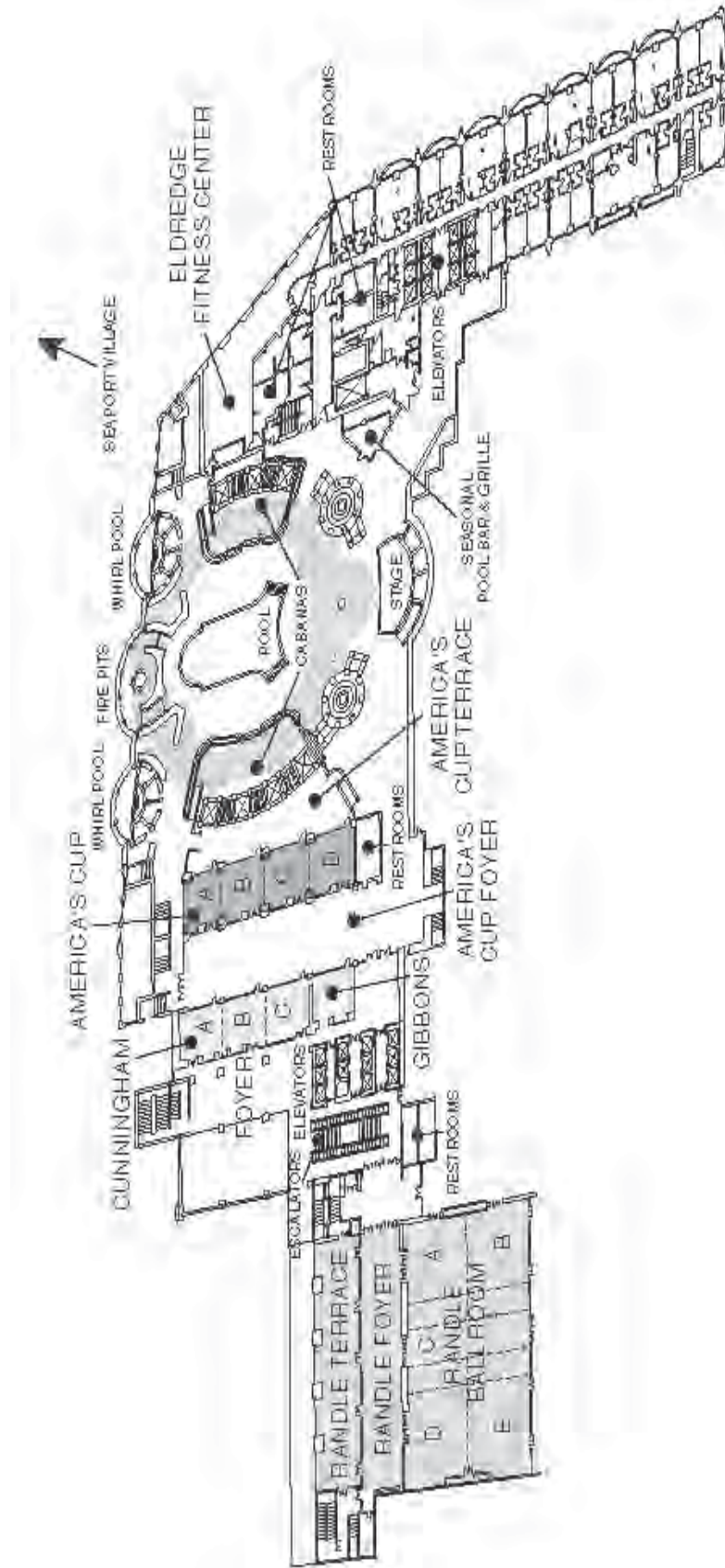

2010 Conference Planner

Date and Time	Event	Session #	Location
Monday, April 19			
6:45 AM – 5:00 PM	<i>Advance & On-site Registration</i>		Elizabeth Foyer
6:45 AM – 7:30 AM	Complimentary Continental Breakfast – MIND Research Institute		Douglas Foyer
7:30 AM – 9:00 AM	Opening Session & Keynote		Douglas Pavilion CD
9:30 AM – 10:30 AM			
9:30 AM – 11:30 AM			
10:45 AM – 11:45 AM			
11:00 AM – 5:00 PM	<i>Sponsor Displays</i>		Elizabeth CDE
11:30 AM – 12:45 PM	Box Lunch – Didax (ticket required)		Elizabeth CDE
12:45 PM – 1:00 PM	Box Lunch Wait List (first come/first served)		Elizabeth CDE
12:00 PM – 2:00 PM			
12:15 PM – 1:15 PM			
1:30 PM – 2:30 PM			
2:45 PM – 3:45 PM			
2:45 PM – 4:45 PM			
4:00 PM – 5:00 PM			
5:15 PM – 6:45 PM	Regional Leadership Team Meeting (by invitation only)		
Tuesday, April 20			
6:45 AM–12:15 PM	<i>Advance & On-site Registration</i>		Elizabeth Foyer
7:30 AM – 8:30 AM	Breakfast – Tom Snyder Productions, A Scholastic Company (ticket required)		Douglas Pavilion CD
8:30 AM –12:15 PM	<i>Sponsor Displays</i>		Elizabeth CDE
8:45 AM – 9:45 AM			
8:45 AM – 10:15 AM			
10:15 AM – 11:15 AM			
10:30 AM – 12:00 PM			
12:15 PM – 2:15 PM	Luncheon – Texas Instruments (ticket required)		Douglas Pavilion CD
2:15 PM – 4:00 PM	<i>Sponsor Displays</i>		Elizabeth CDE
2:15 PM – 5:00 PM	<i>Advance & On-site Registration</i>		Elizabeth Foyer
2:30 PM – 3:30 PM			
2:30 PM – 4:00 PM			
4:00 PM – 5:30 PM	Caucus Meetings		
5:45 PM – 7:00 PM	Reception – Pearson (ticket required)		Douglas Pavilion CD
Wednesday, April 21			
7:30 AM – 10:30 AM	<i>Advance & On-site Registration</i>		Elizabeth Foyer
7:30 AM – 8:30 AM	Breakfast – America's Choice (ticket required)		Douglas Pavilion CD
8:45 AM – 9:45 AM			
8:45 AM – 10:15 AM			
10:15 AM – 11:15 AM			
10:30 AM – 11:30 AM			
11:15 AM – 12:15 PM			
12:30 PM – 2:30 PM	Luncheon – CASIO America, Inc. & Houghton Mifflin Harcourt (ticket required)		Douglas Pavilion CD
2:45 PM – 4:00 PM	Special Interest Group Meetings		Levels 2, 3, 4